

Pressure Relief Valves 3,000 - 10,000 - 25,000 - 66,000 PSI

Maxpro proportional relief valves are designed to protect systems and components against over-pressure for both gas and liquid applications. The unique poppet design allows for chatter free pressure release and excellent deadband pressure control.

The soft seat design (MT3RV, MT10RV and MT25RV) provides bubble-tight shut-off and increased cycle life.

These proportional relief valves are designed to open gradually as the pressure increases, they are not recommended for full capacity at a given pressure, and therefore are not certified to ASME code requirements.

Relief Valve Features:

- Gas or Liquid Service
- 316L Stainless Steel Body
- Nylon Seats (MT3RV, MT10RV & MT25RV)
- Seal materials are PTFE/EPDM
- Panel mounting
- Externally adjustable
- Safety weep hole for seal area leak detection
- Temperature Range -0°F to 200°F
- Factory pressure setting available
- Preset and locked cracking pressure “-L”



Repair Kits - Consult your **MAXPRO** representative for repair kits and valve bodies. Refer to the Tools and Installation section for proper maintenance procedures.

Catalog Number	Connection Size		Orifice (in.)	Service	Pressure Rating (psi) @ R.T.		Valve Panel Hole	Body Diameter
	Inlet	Outlet			Minimum Setting	Maximum Setting		
MT3RV	1/4" FNPT (2)	1/4 FNPT	0.070	Liquid/Gas	500	3,000	1.38	1.50
MT10RV	1/4" FNPT (2)	1/4 FNPT	0.070	Liquid/Gas	1,000	10,000	1.38	1.50
MT25RV	1/4" H.P.	1/4 FNPT	0.070	Liquid/Gas	2,500	25,000	1.625	2.00
MT66RV	1/4" U.H.P.	1/4 FNPT	0.070	Liquid/Gas*	10,000	66,000	1.625	2.00

*Not bubble tight on gas service. When selecting multiple items, the pressure rating would be that of the lowest rated components.

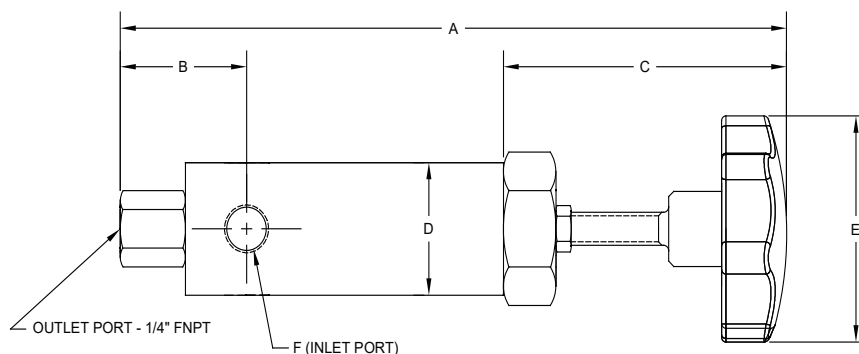

Dimension	MT3RV/ MT10RV	MT25RV	MT66RV
A	8.13"	9.94"	9.94"
B	1.56"	2.13"	2.13"
C	3.50"	1.68"	1.68"
D	1.50"	2.00"	2.00"
E	2.50"	.56"	.56"
F	1/4" FNPT	1/4" H.P.	1/4" U.H.P.

MT R6 05/2021

All general terms and conditions of sale, including limitations of our liability, apply to all products and services sold.